

Timer Adjustment Options and Dials



Approvals: cULus

Versa-Pot

Description

Panel mountable, industrial potentiometer recommended for remote time delay adjustment. The shaft is slotted for screwdriver adjustment and serrated for slip-proof finger adjustment. Accepts Versa-Knob or Lock Shaft. May be ordered with two 8 in. (20.3 cm) wires soldered to pot (clockwise increase) and female quick connect terminals on other ends by adding suffix -X to end of part number.

Versa Pot P/N	With Wire Leads	Value
P1004-198		25KΩ
P1004-199		50KΩ
P1004-95	•P1004-95-X	100KΩ
P1004-17		500KΩ
•P1004-16	•P1004-16-X	1 MΩ
P1004-15		1.5 MΩ
•P1004-12	•P1004-12-X	3 MΩ
P1004-13		5 MΩ

Specifications	
Rating	0.25W at 55°C
Taper	Linear
Shaft Rotation	300° +/-5°
Tolerance	+/-10%

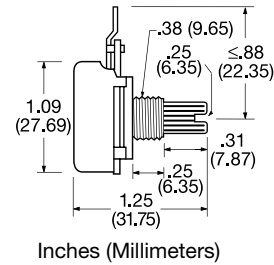

Versa-Knob

Description

Versa-Knob is designed for 0.25 in (6.35 mm) shaft of Versa-Pot or Q-Pot. Semi-Gloss industrial black finish.

P/N: •P0700-7

SS = Set Screw

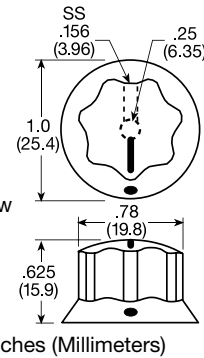

Lock Shaft

Description

Fits 0.25 in. (6.35 mm) potentiometer shafts. Locks by tightening nut onto four tapered/slotted fingers. Pressure on the shaft locks control against mis-adjustment. Nickel plated brass finish.

P/N: P0700-8

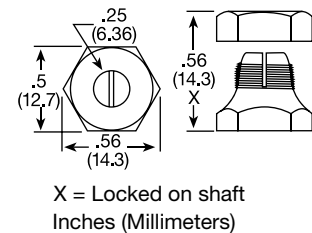



Mini-Pot

Description

A high quality, industrial potentiometer for remote time delay adjustment. The shaft extends through the timer's center hole for easy panel mounting. Use mini-mount bracket for standup mounting of timer. Adjustment by screwdriver or mini-knob. May be ordered with two 3 in. (7.6 cm) wires soldered to pot (clockwise increase) and female quick connect terminals on other ends by adding suffix -X to end of part number.

P/N	With Wire Leads	Value
P1004-10	P1004-10-X	1 MΩ
P1004-31	P1004-31-X	3 MΩ

Mini-Knob

Description

Black plastic control knob with fluted body and white index/dot for setting accuracy. Mounts on 0.125 in. (3.2 mm) shaft of Mini-Pot.

P/N: •P0700-21



Specifications	
Rating	0.25W at 55°C
Taper	Linear
Shaft Rotation	300° +/-5°
Tolerance	+/-10%

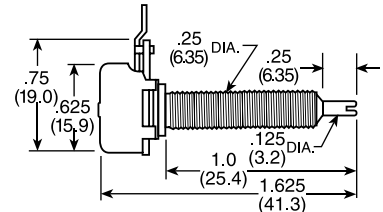

Inches (Millimeters)

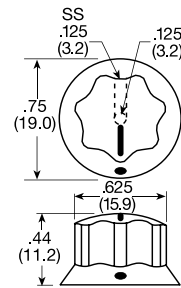

SS = Set Screw
Inches (Millimeters)

Time Adjustment Dials

Description

Dials for use with remote Versa-Pot and panel mounted Mini-Pot. Reverse screen printed on clear plastic to avoid damage to printed image.



P/N	Range	Increments	P/N	Range	Increments
P0400-12	.05 ... 1s	0.1s	P0400-20	2 ... 180s	30s
P0400-13	.05 ... 2s	0.2s	P0400-21	0.1 ... 4m	0.5m
P0400-14	.05 ... 3s	0.5s	P0400-22	0.1 ... 5m	0.5m
P0400-15	0.1 ... 5s	0.5s	P0400-23	0.1 ... 6m	1m
P0400-82	0.1 ... 10s	1s	P0400-24	0.1 ... 7m	1m
P0400-17	1 ... 30s	5s	P0400-25	0.1 ... 8m	1m
P0400-83	1 ... 60s	10s	P0400-26	0.1 ... 10m	1m
P0400-19	2 ... 120s	20s	P0400-27	0...10	MRD*

*Multiplier Reference Dial

Available Models-

P0400-17	P0400-27	•P0400-82
P0400-83	P0400-86	

Don't see what you need? Call us for a minimum quantity and price quote!

VTP

Description

The VTP Series mounts on modules with in-line adjustment terminals. Rated at 0.25W at 55°C. Available in resistance values from 5KΩ to 5MΩ.

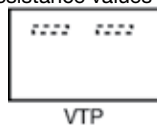

Top View

Ordering Table (select one from each column)

Series	R _T Value	Range
VTP	A - 5KΩ	A - 0.05 ... 1 s
	B - 10KΩ	B - 0.05 ... 3 s
	C - 20KΩ	C - 0.1 ... 10 s
	D - 50KΩ	D - 0.5 ... 10 s
	0 - 250KΩ	E - 0.5 ... 20 s
	1 - 0.5 MΩ	F - 0.5 ... 60 s
	2 - 1 MΩ	G - 1 ... 100 s
	3 - 2 MΩ	H - 2 ... 120 s
	4 - 3 MΩ	J - 2 ... 180 s
	5 - 5 MΩ	K - 10 ... 1000 s
VTP1D		L - 0.1 ... 4 m
VTP2E		M - 0.1 ... 6 m
VTP2J		N - 0.1 ... 10 m
•VTP4B		P - 1 ... 100 m
VTP5C		R - 0 ... 10 MRD*
VTP5P		S - 0.1 ... 8 m
		T - 0.1 ... 5 m
		X - All time range labels

*Multiplier Reference Dial

Available Models-

VTP0E	VTP1B
VTP2A	VTP2C
VTP2F	VTP2G
VTP2P	VTP3B
•VTP4F	•VTP4J
•VTP5G	•VTP5N
VTPDF	

Don't see what you need? Call us for a minimum quantity and price quote!

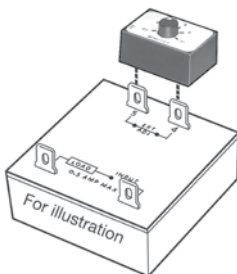

Approvals: